

## 2K Spray Topcoat

### Technical Data Sheet (TDS)

#### Product Description

**Endura 2K Spray** is Endura two component coating packaged in easy to use aerosol.

#### Product features:

- Twice the volume solids of conventional aerosol products
- Professional spray gun quality results
- Easy to use
- No mess or measuring
- Quick activation
- No equipment needed

#### Recommended Uses

Endura 2K spray Topcoat is a high performance coating excellent for repairs, or for painting smaller projects.

Please read the technical Data Sheet for the specific product being sprayed for additional important suitability and surface preparation information.

#### Product Characteristics

**Finish:** varies by product

**Volume Solids:** N/A Depending on product, please see specific product TDS for more information

**Pot Life:** 24 Hours @ 77°F (25°C) and 50% RH  
Once activated the Endura 2K spray remains spray-able for one day.

**VOC** (EPA Method 24): varies by product

**Shelf Life\*:** 1 year

*\*For un-activated product.*

#### Current Endura 2K products

Endura 2K aerosols (16oz) are currently available in the following products:

- Endura 2K aerosols (16oz) are currently available in the following products:
  - EX-2C
  - EasyClean
  - UltraFlex

#### Activating 2K Spray

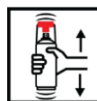

Shake can vigorously for 2 minutes (after mixing ball rattles) minimum before activating.

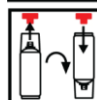

To Activate: Take red button from cap and attach it to the pin on the aerosol bottom. Put aerosol with cap upside down on a stable surface.

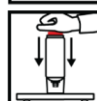

Press red button with the ball of your hand until stop is reached.



Shake aerosol again vigorously for 2 minutes more to mix paint with hardener.

#### Application Method

Once product is activated, do a test spray to check nozzle flow, substrate compatibility and color correctness. The spray fan can be adjusted for vertical or horizontal spray by turning the yellow nozzle orifice. Spraying distance is 8-10 inches from the surface being painted.

#### Clean Up

To prevent the nozzle from clogging, turn can upside down and spray nozzle until only propellant is being sprayed (approx. 2 seconds) between uses.

When work is finished, reverse aerosol and spray valve empty. The emptied aerosols are suitable for household collection.

#### Environmental Conditions

For optimum coating performance product, substrate and ambient temperature should be between 20°C-25°C\* (68°F-77°F). To prevent condensation during application the surface temperature must be 3°C (5°F) or more above the dew point at all times.

#### Safety Precautions

Please refer to all Safety Data Sheets (SDS) before using this product. SDS sheets can be found on our website at [www.endura.ca](http://www.endura.ca).